

# LED HAND LAMP AND LED DOWN LIGHT

## TYPE : LHG-A11-D / A12-D / LHG-D10

- The brightness that is near to a 100W incandescent electric lamp work light.
- 10-13W a little as for the consumption electricity. About 1/10 of the incandescence work light
- Longer life 40,000h ■ The glove has taking a polycarbonate that is good impact resistance and weather resistance.
- An appliance does not become hot even if an appliance turns on for a long time
- Prepare two types of AC100V and AC200V
- The DC type supports the wide input voltage range ■ It conform to EN55015/EN61547 As noise measures
- AC types are with dimming function (Dimmer not included)

Model	LHG-D10	LHG-A11-D	LHG-A12-D
Range of input voltage	DC24V (DC20-32V)	AC100 (AC100-120V±10%)	AC220V (AC200-240V±10%)
Input current	Approx.0.42A	Approx.0.1A	Approx.0.06A
Power consumption	10W	Max.13W	Max.12W
Power factor	—	0.9	0.9
Color temperature	5000K	5000K	5000K
Luminous flux	950lm	930lm	900lm
Weight	Approx.0.8kg	0.8kg	0.8kg
Color	7.5BG7/2		

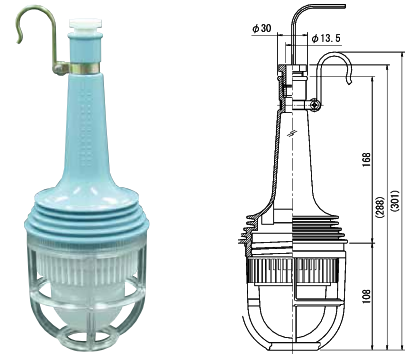

## LED DOWN LIGHT TYPE: LDW-150Series

- Low power consumption ■ Longer life 40,000h
- We have the single color type that is with dimmer switch and no switch
- We have a product in conformity to an AC type and DC type
- We have a full color type(red,white) and a reshuffling type
- It conform to EN55015/EN61547 As noise measures

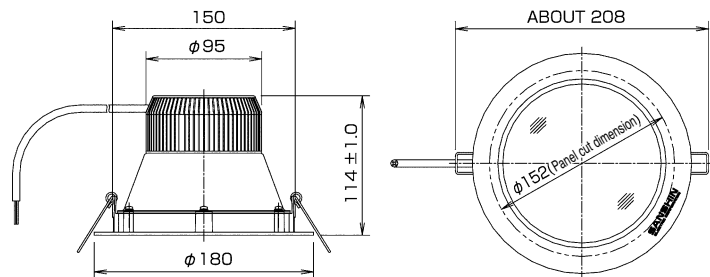

Model	color temperature	Dimmer function	color temperature	Input current	Luminous flux	Luminous flux	Weigh	External power supply presence
LDW-150MA1-A	×	○	3000K	AC100-120V ± 10%	Max.13W	750 lm	0.56	on
LDW-150MA2-A	×	○	3000K	AC200-240V ± 10%	Max.13W	750 lm	0.56	on
LDW-150MD	×	○	3000K	DC20-32V	Max.11W	585 lm	0.58	off
LDW-150MNA	×	×	3000K	AC100-240V ± 10%	Max.12W	585 lm	0.56	on
LDW-150MND	×	×	3000K	DC20-32V	Max.10W	585 lm	0.58	off
LDW-150MA1AM	○	○	—	AC100V-110V ± 10%	Max.13W	130 lm	0.56	on

- Single color power supply mass 0.15kg ■ Weight for power unit with 0.32kg The dimmer switch as option

## EXPLOSION PROOF LED CEILING LIGHT Model : LF1-01

- Explosion proof grade : EExd IIC T6/4/3 ZONE 1 + ZONE 2
- Certificate No.: INERIS 15ATEX0006X , IECEx INE 15.0008X
- Ambient temperature : -20°C~40°C
- Protection degree : IP66
- Material : corrosion proof aluminum alloy ( Guard : SUS)
- Color : 7.5BG7/2
- Cable gland : 4 x NPT3/4"
- Input voltage : 100V~240V
- RATING : Max. 11W

