

HIGH POWER LED FLOOD LIGHT

TYPE : LFD280F (Wide beam type)

TYPE : LFD280N (Narrow beam type)

- Realize the optical axis intensity of light of the mercury lamp 1000W equivalency
- Available select the beam angles from narrow and wide beam.
- Light weight by the anti-corrosion aluminum alloy body.

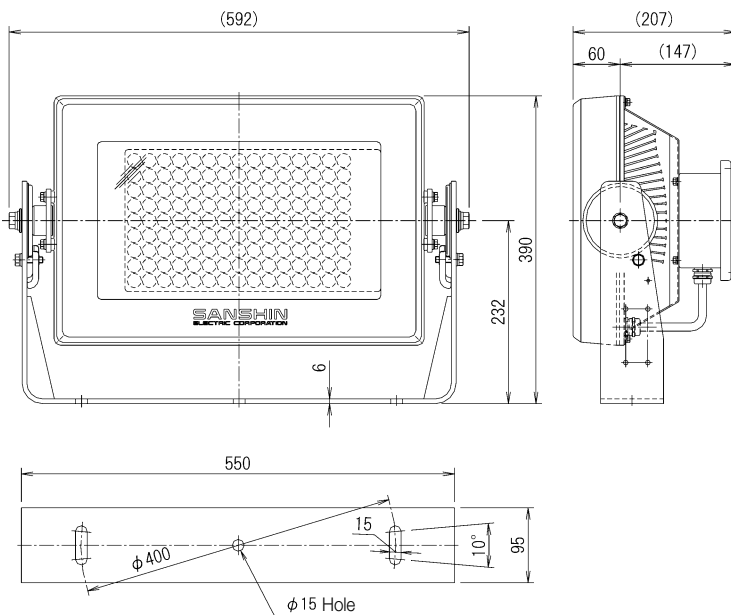

Wide beam type

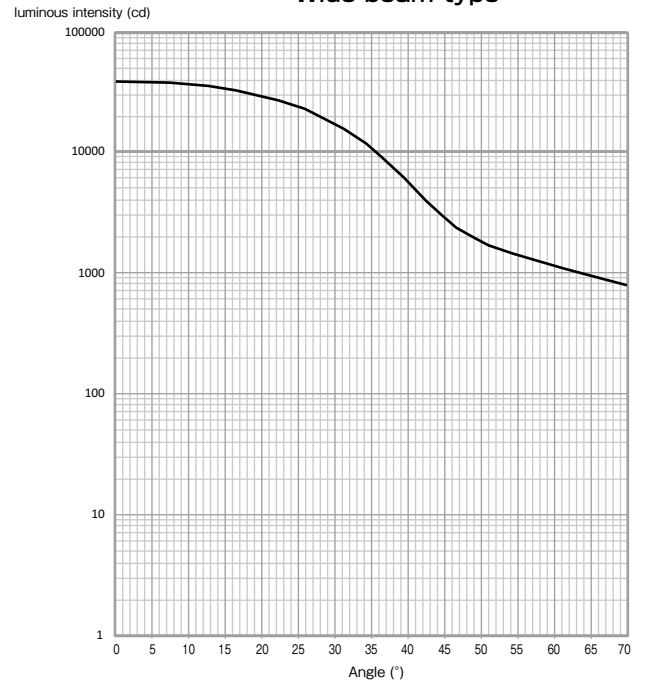

Narrow beam type

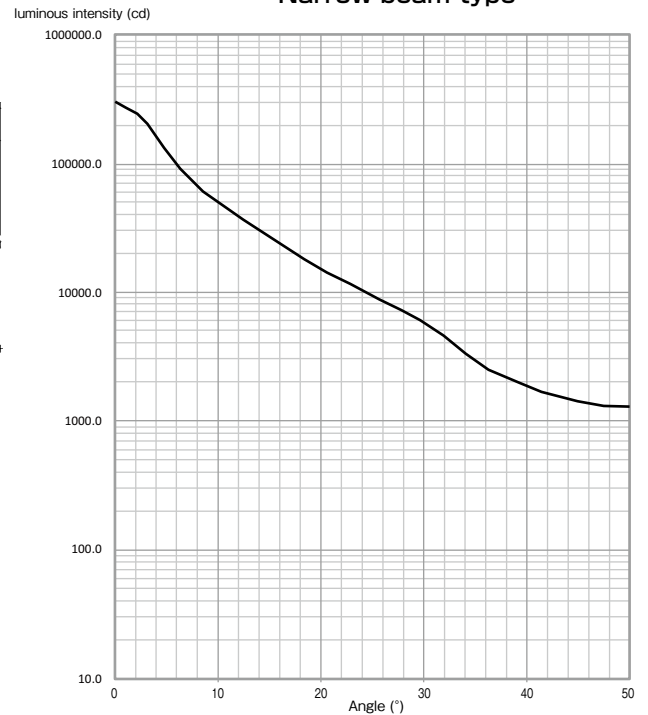

Model	Range of input voltage	Max. luminous intensity	10% of maximum luminous intensity	Input current	Input power	Power factor	Weight
LFD 280N	AC100-220V ± 10% 1Φ 50/60Hz	280,000cd	Approx. 30°	2.8A (100V) 1.3A (220V)	Approx. 280W (100V) Approx. 275W (220V)	0.99(AC100V) 0.98(AC220V)	21kg
LFD 280F		38,000cd	Approx. 80°				

LED FLOOD LIGHT

TYPE : LFD160F(Wide beam type)

TYPE : LFD160N(Narrow beam type)

- Realize the optical axis intensity of light of the mercury lamp 700W equivalency
- Light weight by the anti-corrosion aluminum alloy body.
- Terminal box (Option)
- Guard (Option)

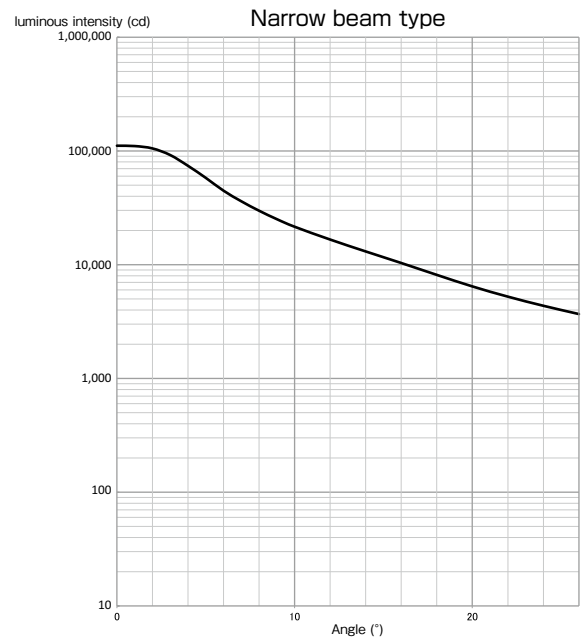
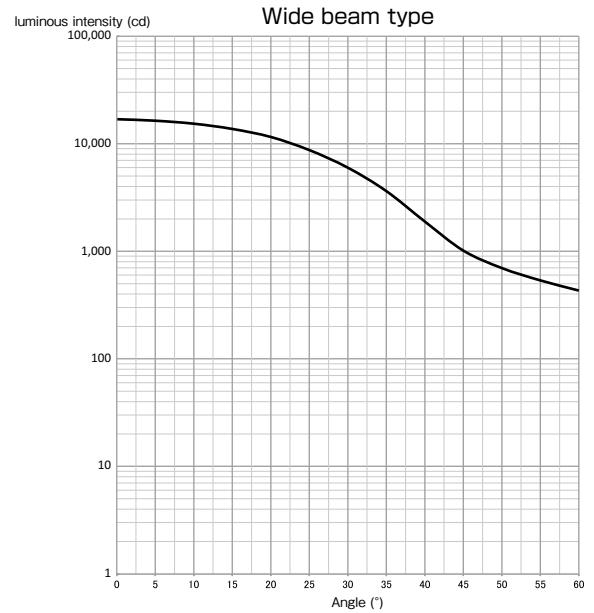
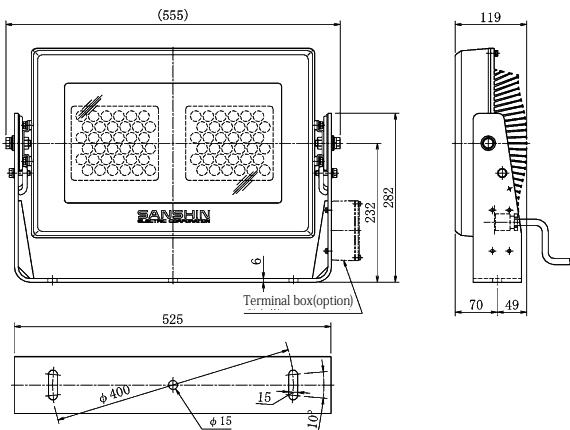

Model	Range of input voltage	Max. luminous intensity	10% of maximum luminous intensity	Input current	Input power	Power factor	Weight
LFD160N	AC100-240V ± 10% 1Φ 50/60Hz	105,000cd	Approx. 30°	1.5A(AC100V) 0.7A(AC220V)	150W	0.99(AC100V)	16.5kg
LFD160F		16,000cd	Approx. 80°			0.94(AC220V)	
LFD160N-D	DC20-32V	105,000cd	Approx. 30°	6A		—	12.6kg
LFD160F-D		16,000cd	Approx. 80°				



It has the shading board every capacity as optionally.

LED FLOOD LIGHT

TYPE : LFD80F (Wide beam type)

TYPE : LFD80N (Narrow beam type)



Realize the optical axis intensity of light of the mercury lamp 400W equivalency

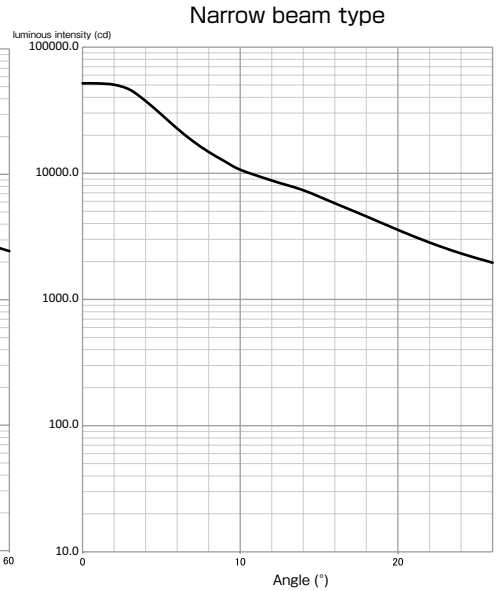
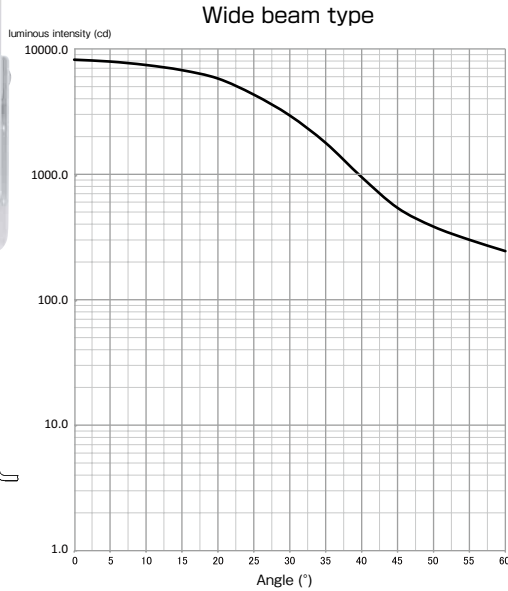
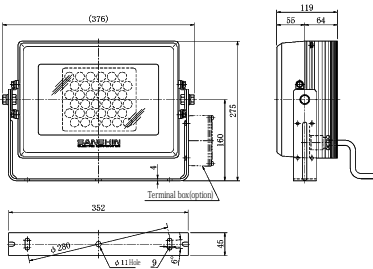

Model	Range of input voltage	Max. luminous intensity	10% of maximum luminous intensity	Input current	Input power	Power factor	Weight
LFD80N	AC100-240V ± 10% 1Φ 50/60Hz	53,000cd	Approx. 30°	0.75A(AC100V) 0.35A(AC220V)	75W	0.99(AC100V)	7.5kg
LFD80F		8,000cd	Approx. 80°			0.94(AC220V)	
LFD80N-D	DC20-32V	53,000cd	Approx. 30°	3A		—	5.8kg
LFD80F-D		8,000cd	Approx. 80°				

TYPE: FDL-021L



The brightness that is equal to a 300W halogen bulb floodlight (Optical axis intensity of light 3,300cd)

The light body is made by corrosion resistance aluminum alloy and is small and light

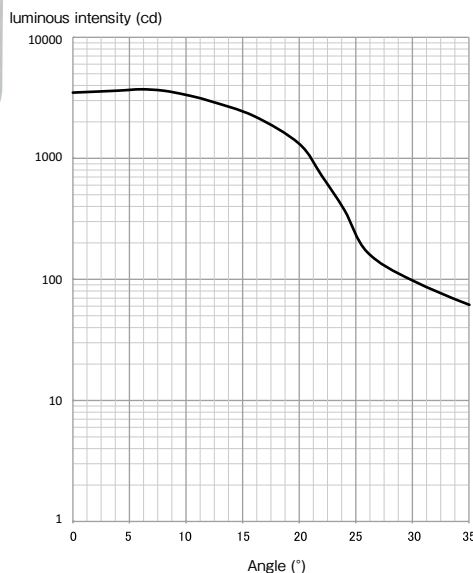
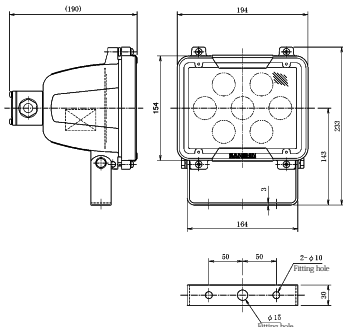

input voltage	AC100-240V -15% +10% 50/60Hz	DC21 - DC30V
Max. luminous intensity	3300cd	
10% of maximum luminous intensity	47°	
color temperature	6200K	
Input current	0.34A(AC100V) 0.15A(AC220V)	0.9A
Weight	2.4Kg	

LED FLOOD LIGHT

TYPE : SOP-60

- This is same brightness with halogen lamp 300W.
- We are prepare the 3 voltage type that is DC24V,AC100V,AC220V.
Also, we are prepare the 2 type that is Narrow beam type and Wide beam type.
- Power consumption is approx..56W, Weight is approx..2kgs.
- Easy replacement from conventional halogen type flood light (FDL-H333) to LED flood light that is the installation pitch is same.
- We are currently developing 2gang, 3gang, 4gang type.



F(Wide beam type)



(Narrow beam type)

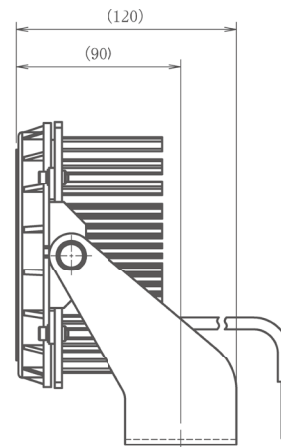
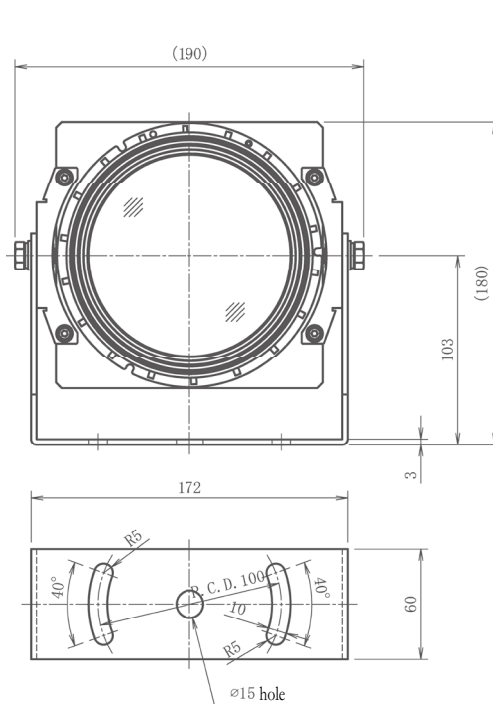

Model	SOP-60A10N(Narrow Beam)/F(Wide Beam)	SOP-60A20N(Narrow Beam)/F(Wide Beam)	SOP-60DN(Narrow Beam)/F(Wide Beam)
Input voltage	AC100V	AC220V	DC24V
Input power	Approx. 0.6A	Approx. 0.3A	Approx. 2.4A
Power consumption	Max.60W		
Color temperature	5000K		
Max. luminous intensity	N(Narrow) 4,800cd / F(Wide) 1,800cd	N(Narrow) 6,800cd / F(Wide)1,800cd	N(Narrow) 7,400cd / F(Wide)1,600cd
Beam spread	N(Narrow Beam) : Approx.80 Degrees over F(Wide beam) Approx. 140 Degrees over		
IP Rated	IP56		
Color	N-9.5(White)		
Weight	Approx.2Kg		
Code	1837S4/1837S3	1837S6/1837S5	1837S2/1837S1