

ANTI-PIRACY SEARCHLIGHT

- New development for the anti-piracy purpose
- Effective to keep guard in the night and to give bedazzlement to suspect vessels or pirates by powerful beam of over 1,000,000cd.
- Xenon lamp or Metal halide lamp 150W
- Suitable for the on deck use "Water tight IP56"
- Various type of installation and operation "Fixed mounting", "Temporary clamp mounting" and "Hand held operation".

Easy operation to connect the plug to the socket-outlet of power source because the ballast is combined with search light. Available to light up around the ship by temporary clamp installation to balustrade on deck. Possible to use as portable search light by connection of the optional extension cable. Available different size of installation clamp on request.

Vice type

RBM-16VB1 (100V)
RBM-16VB2 (220V)

Searchlight specifications

Model	RBM-16VB1	RBM-16VB2
Lamp capacity	150W	
Max. luminous intensity	1,000,000cd	
Beam spread	Approx. 6°	
Elevation angle	Over down 45° Over up 30°	
Turning angle	Right & left each 165°	
Voltage	AC100V 1φ	AC220V 1φ
Frequency	50 / 60Hz	
Input power	Approx. 180W	
Input current	Approx. 1.8A	Approx. 0.8A
Protection degree	IP56	
Weight	10.5kg	12.6kg
Code No.	1030VB1-1A	1030VB2-1A
	(RB-V50A)	(RB-V50A)
	1030VB1-2A	1030VB2-2A
	(RB-V110A)	(RB-V110A)

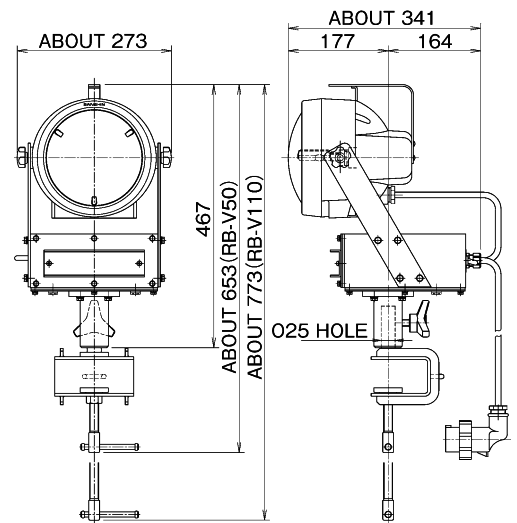

Clamp base specifications

Model	RB-V50A	RB-V110A
Maximum installation width	50mm	110mm
Weight	2.5kg	3kg

Portable type

Possible to operate in long duration because of the light weight and shoulder strap. Easy watching and lighting up from any place. Any installation space is not necessary. Usually storage and use as the need arises. On/Off switch is placed on the ballast box.

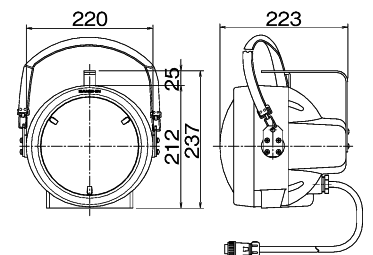

RBM-16PS RBX-16PS

Model	RBM-16PS	RBX-16PS	
Lamp capacity	150W		
Max. luminous intensity	1,000,000cd	660,000cd	
Beam spread	Approx. 6°	Approx. 4°	
Voltage	AC100V 1φ		
	AC220V 1φ (Only xenon)		
Frequency	50 / 60Hz		
Input current	1.8A	1.3A	2.8A
		(100V)	(220V)
Protection degree	IP56 (Search light)		
Weight	3.1kg	3.6kg	
Conformity ballast	BME-150AP	BXE-150AP	
Ballast weight	2.9kg	2.8kg	
Code No.	1030PMS	1029 PXS100	1029 PXS

