

EXPLOSION PROOF HAND LAMPS IL-800 / IL-800EM

The IL-800 / IL-800EM types are rechargeable explosion proof hand lamp with high brightness LED x 3 lights, an output of 200 lumen and service life time of 50,000 hours. The standard specifications are Zone 1 + Zone 2, but selections of products corresponding to Zone 0 areas are possible. They can be used in a wide variety of dangerous areas.

In addition, the IL-800EM type is useful as immediate emergency lighting when the power supply is cut off to the charger because it will automatically turn on.



IL-800

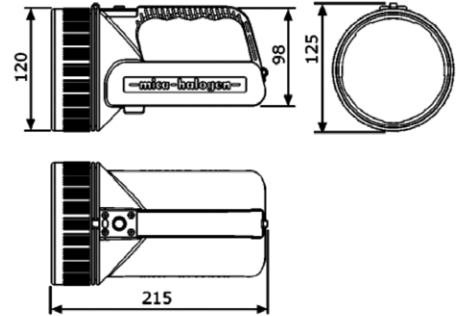

- Conformity standards : EN60079-0 2007-10 Ed. 5.0, EN60079-11 2006-07 Ed. 5.0
EN60079-26 2006-08 2nd Ed., EN60079-28 2006-08 1st Ed.,
EN60079-31 2008-11 Ed. 1.0
- Lamp : High brightness LED x 3 lamps, 200lumen/80lumen(High/Low)
- Material : Electrostatic / shock resistant polypropylene
- Front lens material : Tempered glass (5mm)
- Battery : 6V 4.5Ah rechargeable NiMH battery
- Operation time : 6 hours (High), 12 hours (Low)
- Charging time : 5.5 hours

- Ambient temperature : -20°C~+40°C
- Protection degree : IP67
- Certificate : ATEX II1G EExialIC-T4 ZONE 0
ATEX II2G EExibIIC-T4 ZONE 1 + ZONE 2
- CE marking
- Battery charger : single battery charger AC85~264V
single battery charger DC12~24V
multi battery charger for 3 lights
multi battery charger for 5 lights



ILC-VAC

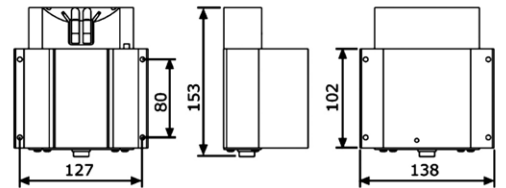

Hand lamp

| Model | IL-800 | | IL-800EM | |
|------------------------------|-----------------------------|-----------------------|-----------------------|-----------------------|
| Lamp | High brightness | | | |
| Intensity of illuminance | 200lumen/80lumen (High/Low) | | | |
| Area | ZONE 0 | ZONE 1 + ZONE 2 | ZONE 0 | ZONE 1 + ZONE 2 |
| Explosion proof grade | ATEX II1G EExialIC-T4 | ATEX II2G EExibIIC-T4 | ATEX II1G EExialIC-T4 | ATEX II2G EExibIIC-T4 |
| Protection degree | IP67 | | | |
| Dimension (mm) | 120 x 125 x 215 | | | |
| Weight (mm) included battery | 1.1 | | | |
| Code No. | A16050050 | A16050051 | A16050052 | A16050053 |

Battery charger

| Model | ILC-3 | ILC-VAC | CR-C3 | CR-C5 |
|-------------------|--------------------------------|----------------|-----------------|-----------------|
| Voltage | DC12~24V | AC85~264V | AC85~264V | AC85~264V |
| Material | Shock resistant PA / aluminium | | Aluminium | |
| Protection degree | IP44 | | | |
| Dimension (mm) | 153 x 138 x 88 | 153 x 138 x 88 | 510 x 227 x 100 | 850 x 227 x 100 |
| Weight (kg) | 0.485 | 0.86 | 3.8 | 5.6 |
| Code No. | A160500437 | A160500438 | A160500439 | A160500440 |

AC/DC adaptor for ILC battery charger

| Model | IL-2 |
|-------------------|--------------------------|
| Voltage | AC90~264V/DC12~24V |
| Material | Shock resistant PC |
| Protection degree | IP20 |
| Dimension (mm) | 97(L) x 45(W) x 55~76(H) |
| Weight (kg) | 0.175 |
| Plug | Europe, USA, UK, & SAA |
| Code No. | A16050048 |



EXPLOSION PROOF HAND LAMPS ML-800 / ML-800EM

The ML-800 / ML-800EM types are compact, rechargeable explosion proof hand lamps with high brightness LED 1W and 3W, an illumination of between 45 and 65 lumen, and a service life time of 50,000 hours. The remaining charge is displayed on the LED bar, and when the battery agts low, a two-stage (when the charge is between about 20 minutes and 5 minutes) blinking signal to warn you to recharge. In addition, the ML-800EM type is useful as immediate emergency lighting when the power supply is cut off to the charger because it will automatically turn on.



ML-800

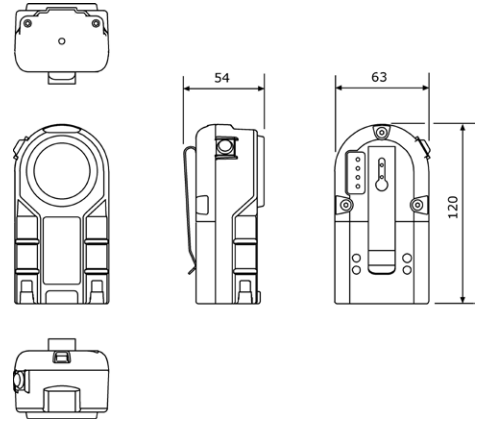

- Conformity standards : EN60079-0 (2006), EN60079-11 (2007)
EN60079-28 (2007), EN60241-0 (2006)
EN60241-11 (2006)

- Battery charger : single battery charger DC12~24V
CR-13(Max. 6 MLC battery charger)
CR-15(Max. 10 MLC battery charger)

- Lamp : High brightness LED 1W, 3W
- Material : Electrostatic / shock resistant polypropylene + aluminium
- Front lens material : Tempered glass (5mm)
- Battery : 6V 1.8Ah rechargeable NiMH battery
- Operation time : 7 hours (1W), 3 hours (3W)
- Charging time : 2.5 hours
- Ambient temperature : -20°C~+40°C
- Protection degree : IP66
- Certificate : ATEX II2G EExibIIC-T4 ZONE 1 + ZONE 2
- CE marking



MLC

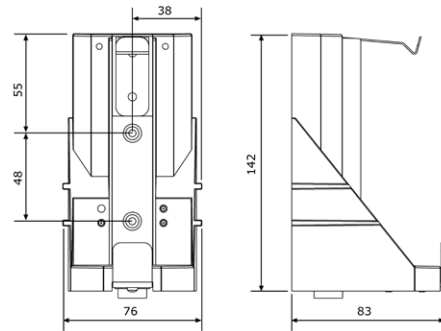

Hand lamp

| Model | ML-800 | | ML-800EM | |
|------------------------------|---------------------------------------|-------------------|-------------------|-------------------|
| | Lamp | 1W | 3W | 1W |
| Intensity of illuminance | 45lumen 1312lx/1m | 65lumen 2670lx/1m | 45lumen 1312lx/1m | 65lumen 2670lx/1m |
| Explosion proof grade | ATEX II2G EExibIIC-T4 ZONE 1 + ZONE 2 | | | |
| Protection degree | IP66 | | | |
| Dimension (mm) | 120 x 63 x 54 | | | |
| Weight (mm) included battery | 0.37 | | | |
| Code No. | A160500430 | A160500432 | A160500441 | A160500442 |

Battery charger

| Model | MLC | CR-13 | CR-15 |
|-------------------|--------------------------------|----------------|----------------|
| Voltage | DC12~24V | MLC x Max.6 | MLC x Max.10 |
| Material | Shock resistant NY / aluminium | Aluminium | |
| Protection degree | IP20 | IP44 | |
| Dimension (mm) | 142 x 83 x 72 | 490 x 210 x 90 | 850 x 208 x 63 |
| Weight (kg) | 0.17 | 3.2 | 5.5 |
| Code No. | A160500433 | A160500443 | A160500444 |

AC/DC adaptor for MLC battery charger

| Model | IL-2 |
|-------------------|--------------------------|
| Voltage | AC90~264V/DC12~24V |
| Material | Shock resistant PC |
| Protection degree | IP20 |
| Dimension (mm) | 97(L) x 45(W) x 55~76(H) |
| Weight (kg) | 0.175 |
| Plug | Europe, USA, UK |
| Code No. | A16050048 |

